

ViviLux Detachable 3x Magnifier Instructions

PRODUCT OVERVIEW

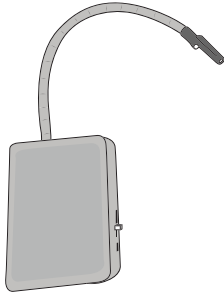

ViviLux LED Light



Magnifier Assembly



Handi-Clip

ASSEMBLY PROCEDURE

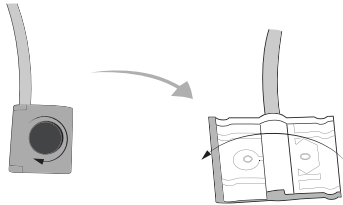

STEP 1

Using knob, uncrew the Magnifier Connector to open it

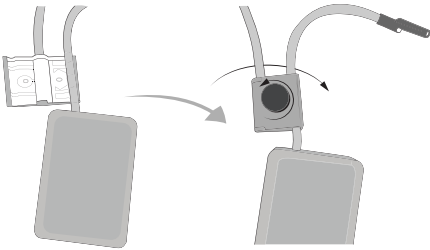

STEP 2

Insert the LED Light flexible arm into the Connector and screw to close. Make sure it is properly closed.

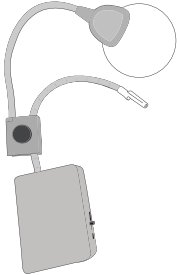

STEP 3

After attaching the Magnifier onto the LED Light arm, confirm the connector is tight. Gently clean the Magnifier just in case you left handprints on it. Your ViviLux Magnifier is now ready to use.

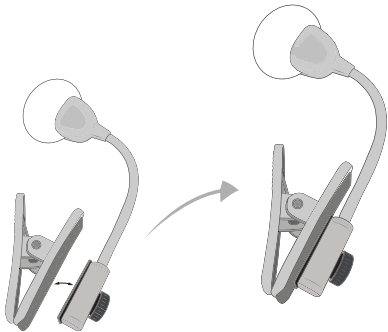

STEP 4

Optional

The ViviLux Magnifier can also be used Free Standing. Use the attached Hook & Loop Tape on the reverse side of the Connector to affix directly to a surface. OR use the enclosed Handi-Clip to turn the ViviLux Magnifier into a Clip-On Magnifier.